

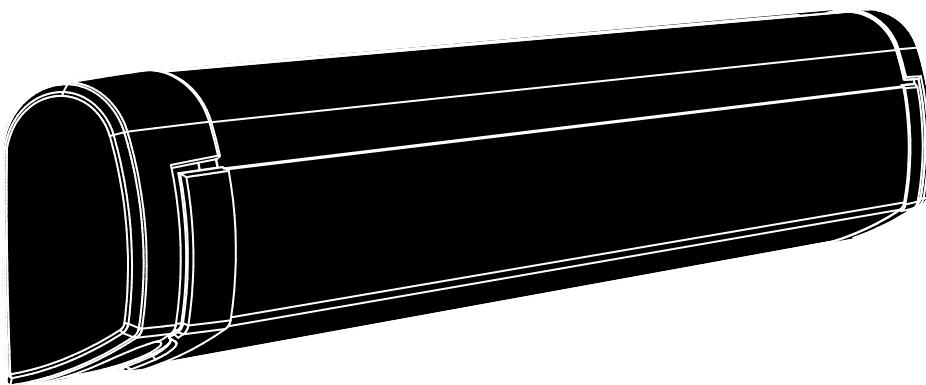

Thule CROWN 5200

➤ Instructions



Manufactured for



LIPPERT
COMPONENTS®

Prod no.: .

Document: 5AT909-01 | 3380042400

Date: 07/12/2016

CCD-0004250

Bring your life
thule.com

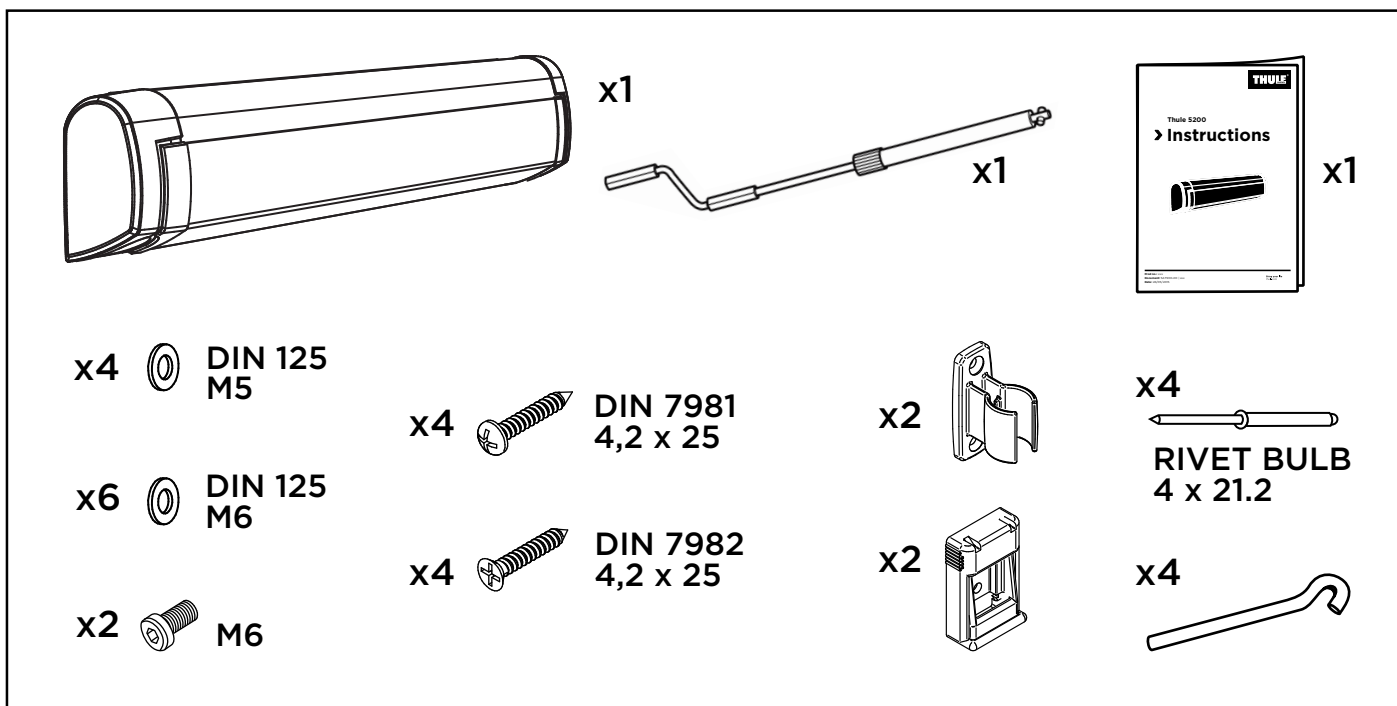
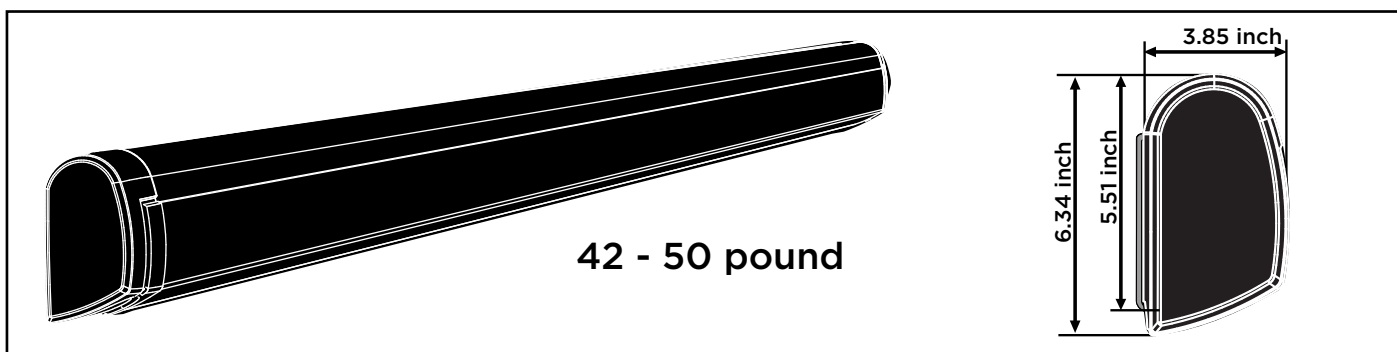
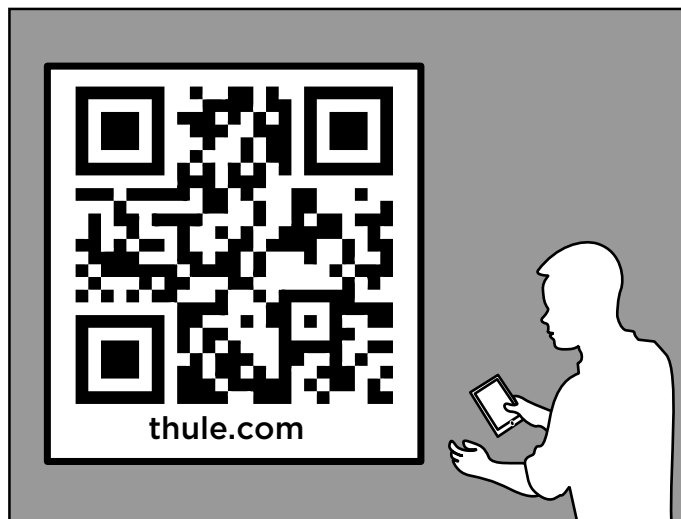
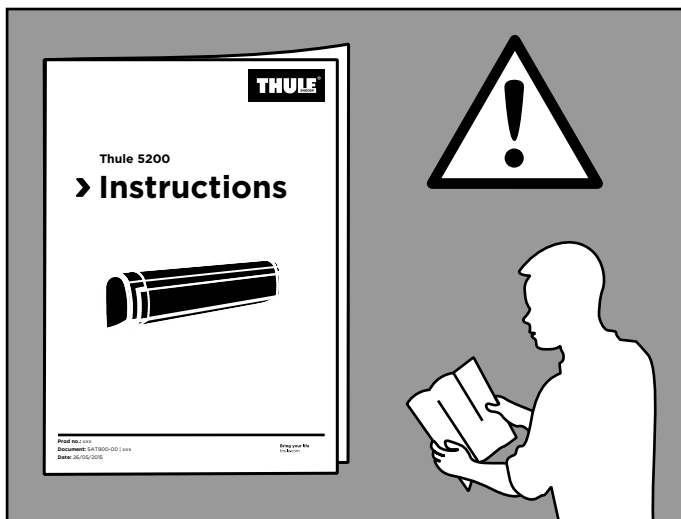

The contents of this manual are proprietary and copyright protected by Lippert Components, Inc. ("LCI"). LCI prohibits the copying or dissemination of portions of this manual unless prior written consent from an authorized LCI representative has been provided. Any unauthorized use shall void any applicable warranty. The information contained in this manual is subject to change without notice and at the sole discretion of LCI. Revised editions are available for free download from lippertcomponents.com.

Please recycle all obsolete materials.

For all concerns or questions, please contact
Lippert Components, Inc.
574-537-8900 | lippertcomponents.com | customerservice@lci.com

INSTALLATION

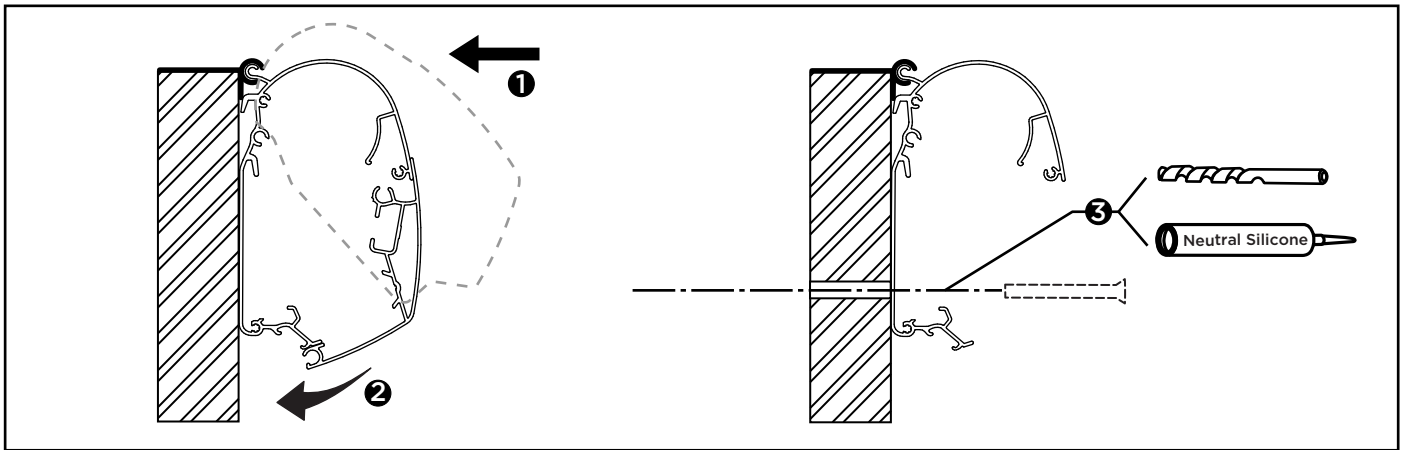
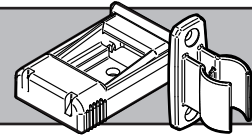

INSTALLATION

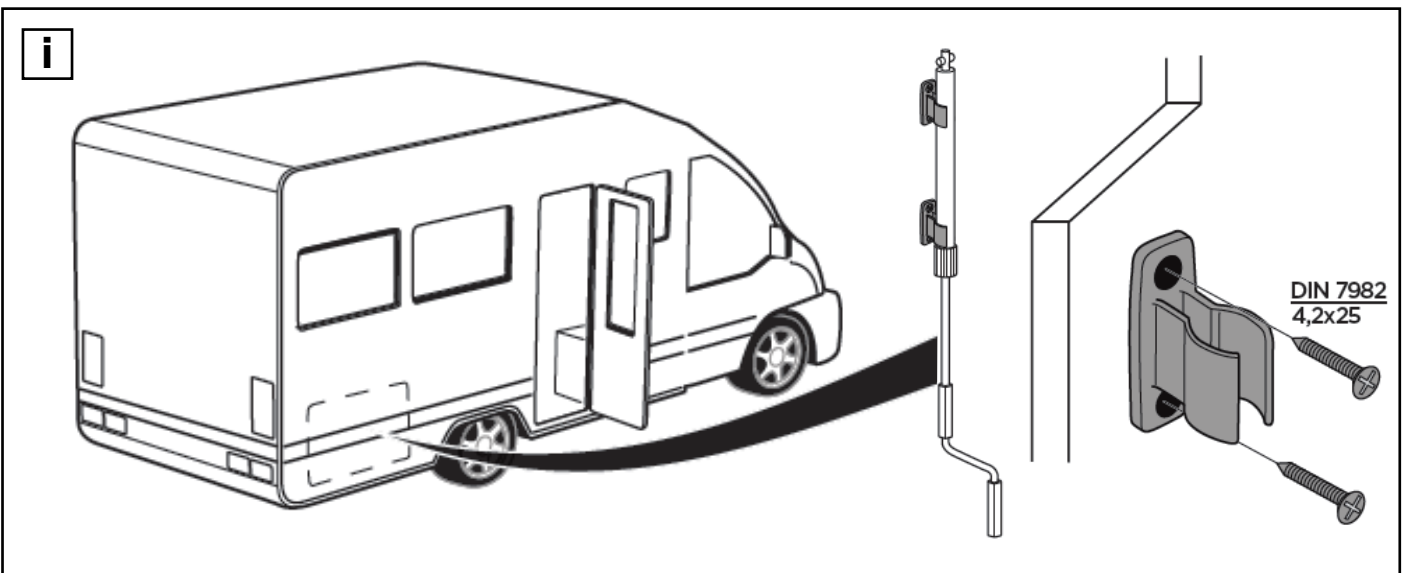
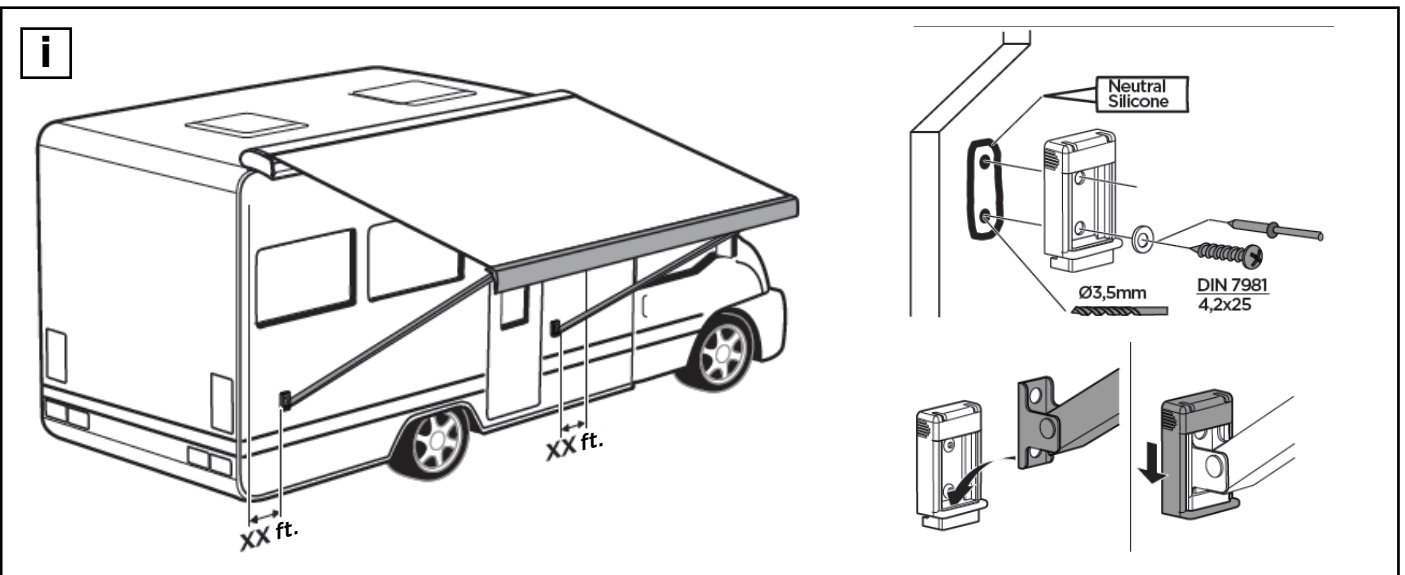
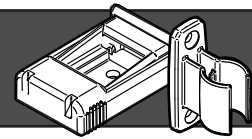
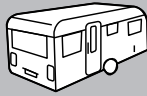

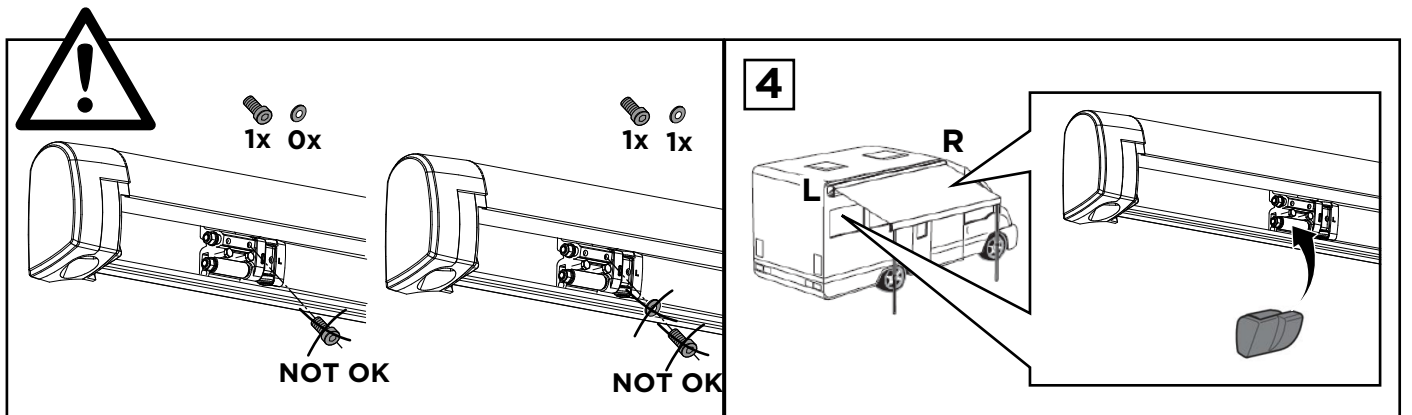
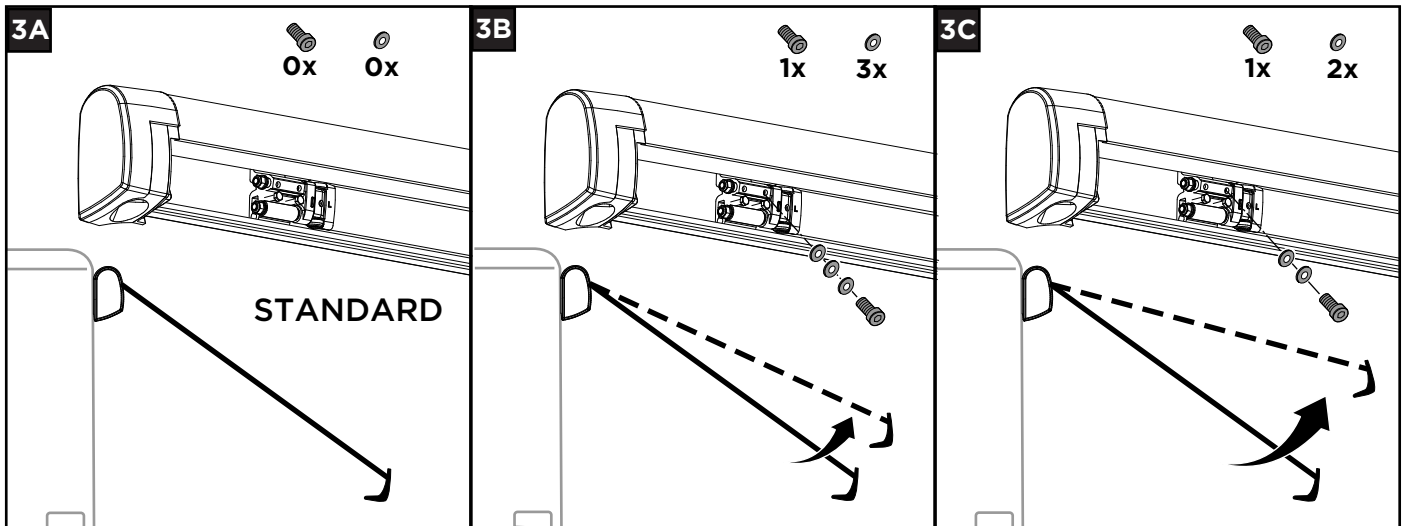
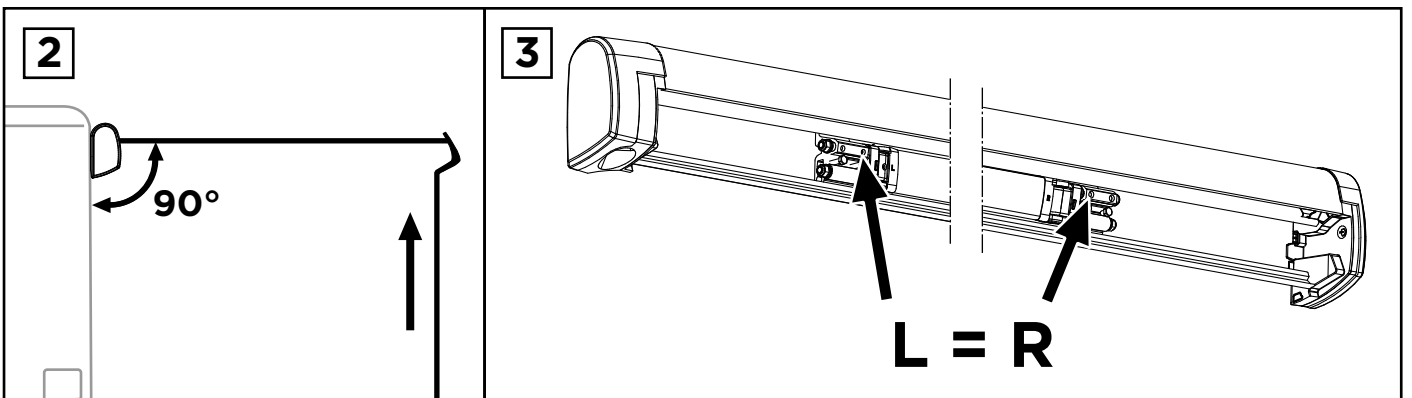
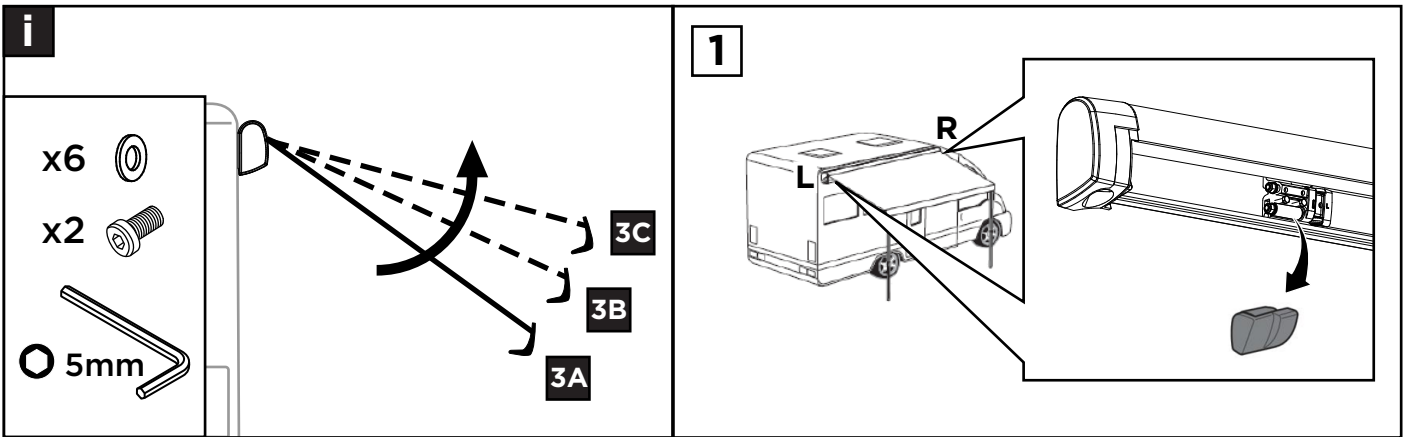

USER MANUAL



CLOSED

OPEN

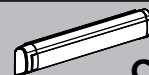
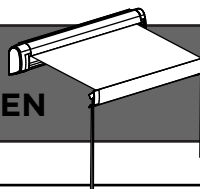

CLOSED

1

A

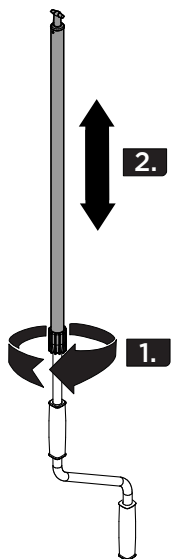

B

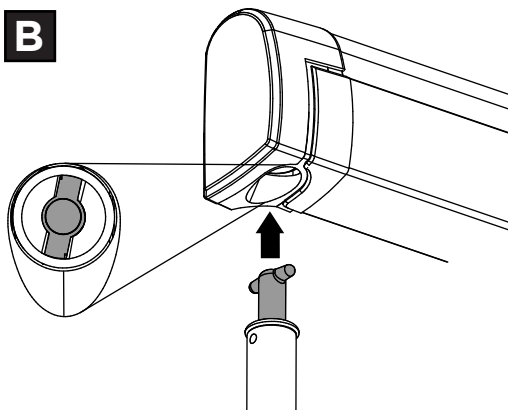

C

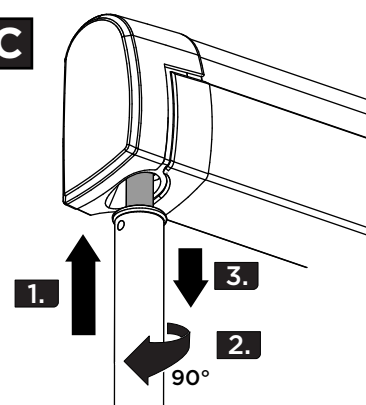

D

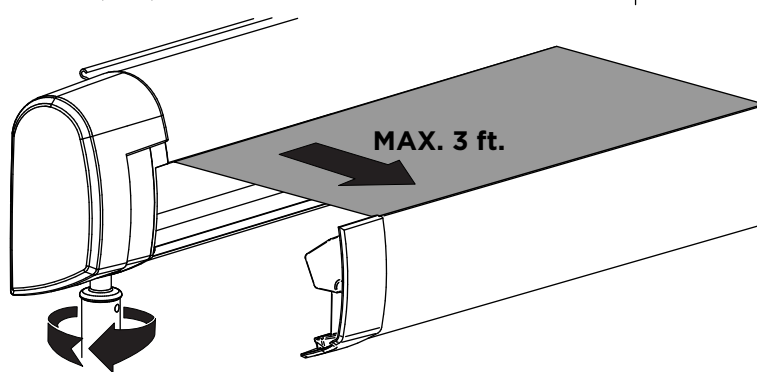

2

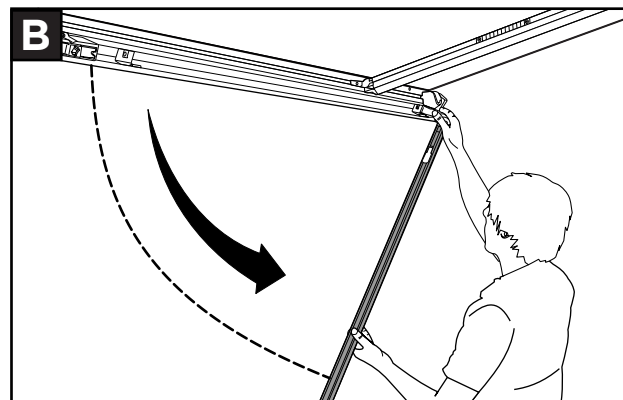
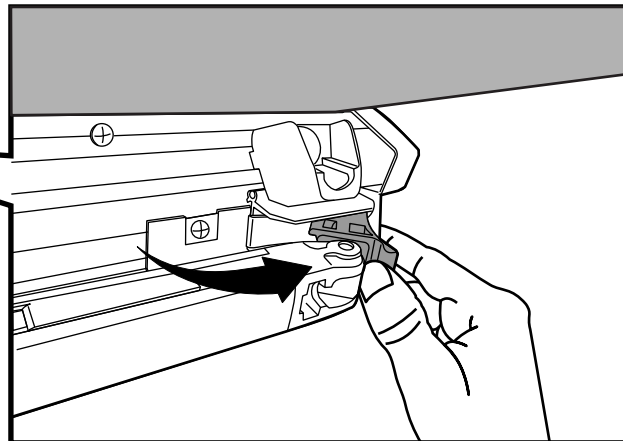
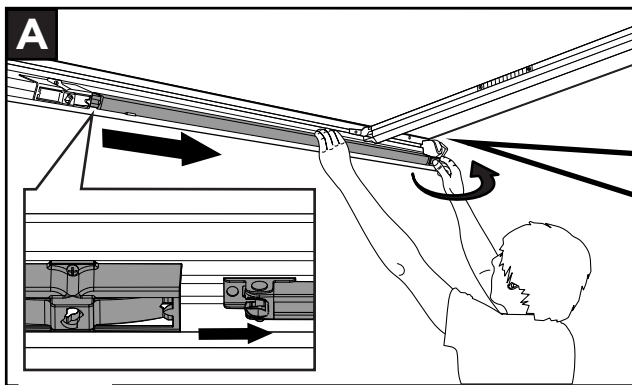



CLOSED

OPEN

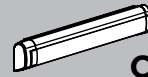
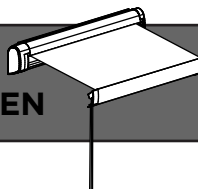

CLOSED

3

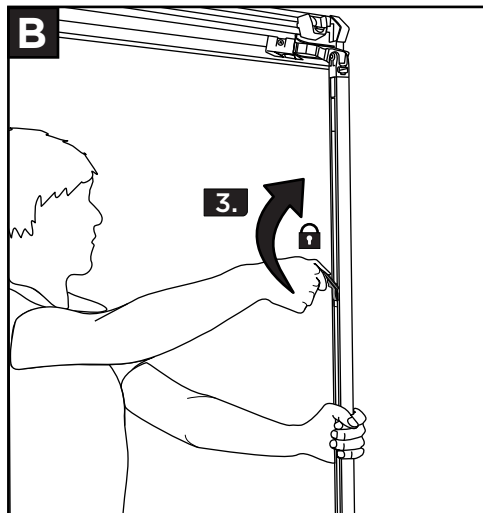
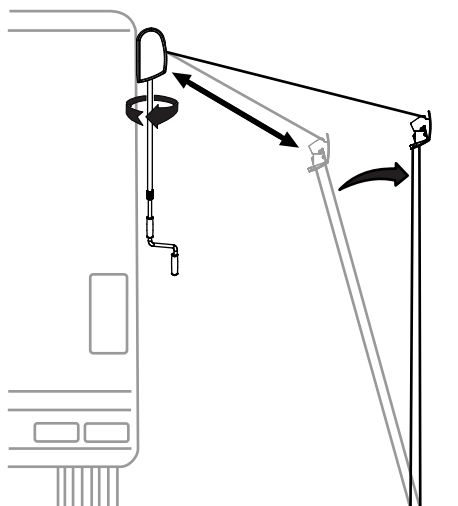
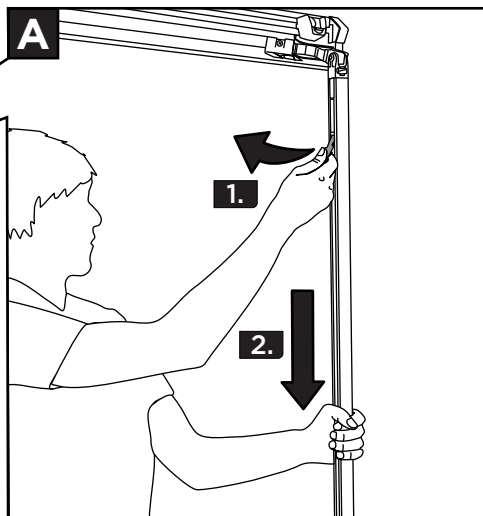
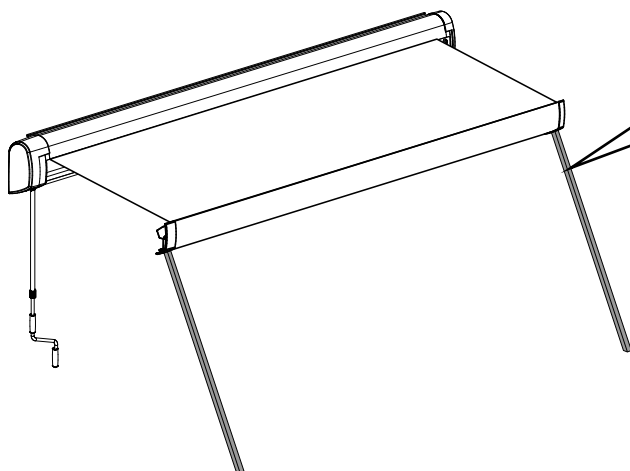

4

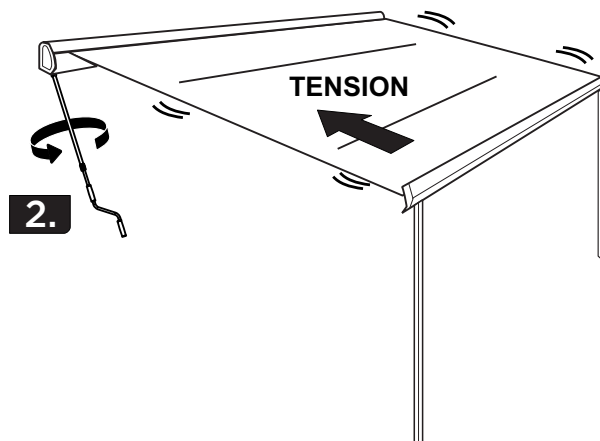
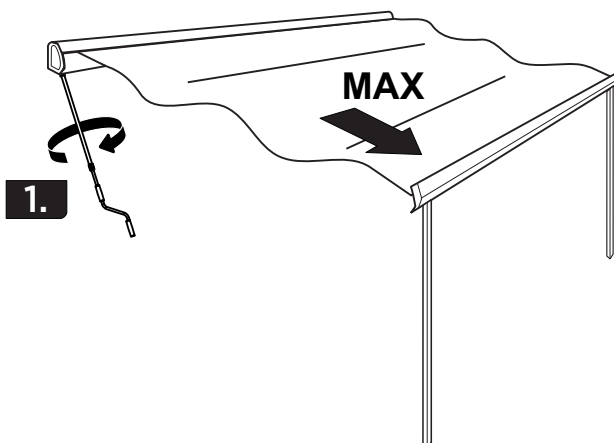

USER MANUAL



CLOSED

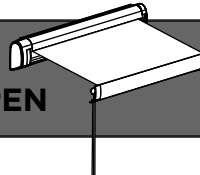

OPEN

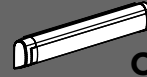

CLOSED

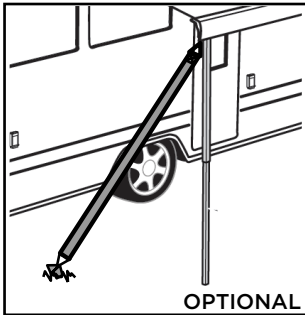
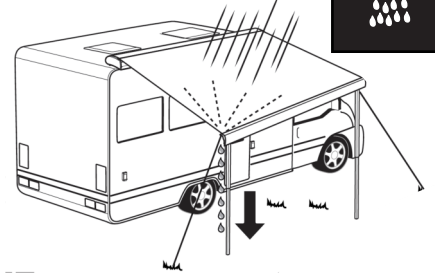
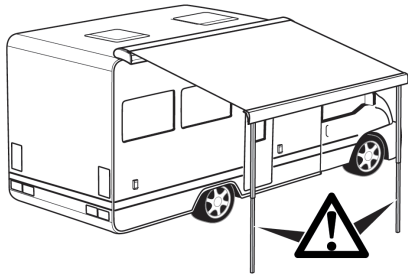

OPTIONAL

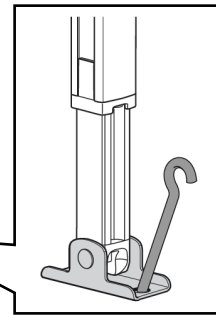
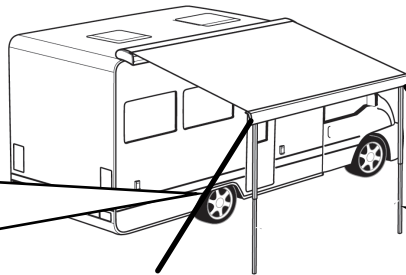

1

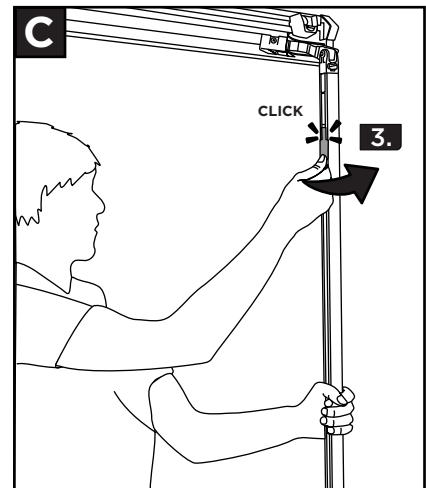
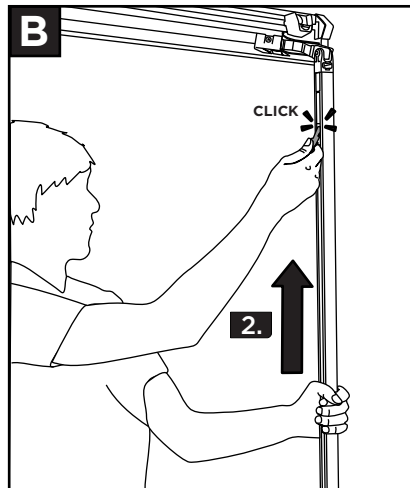
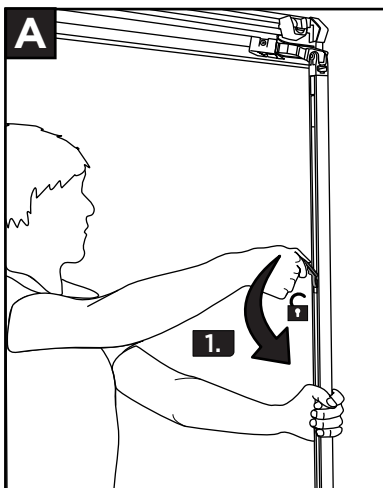
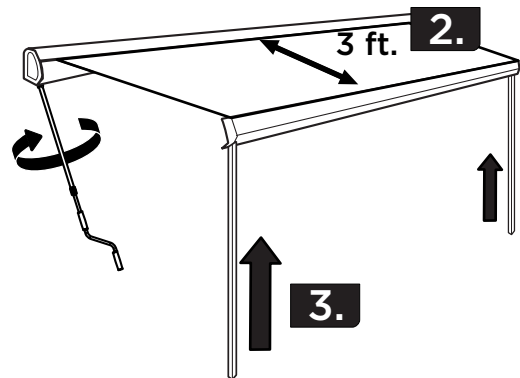
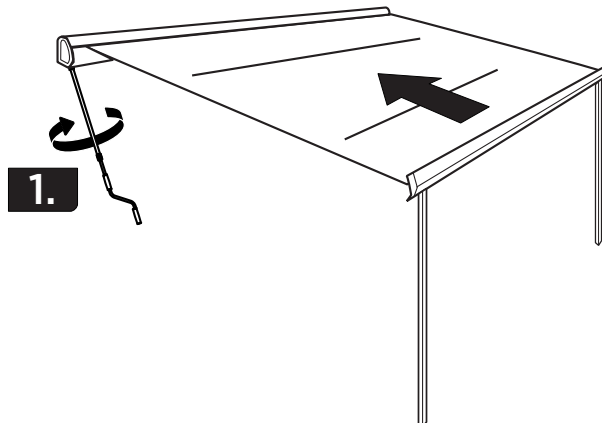

USER MANUAL



CLOSED

OPEN

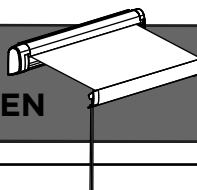

CLOSED

2

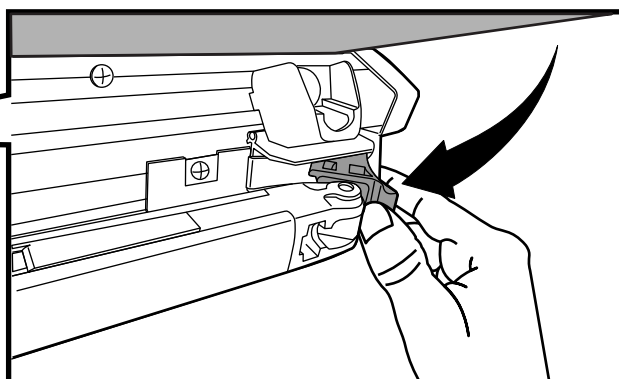
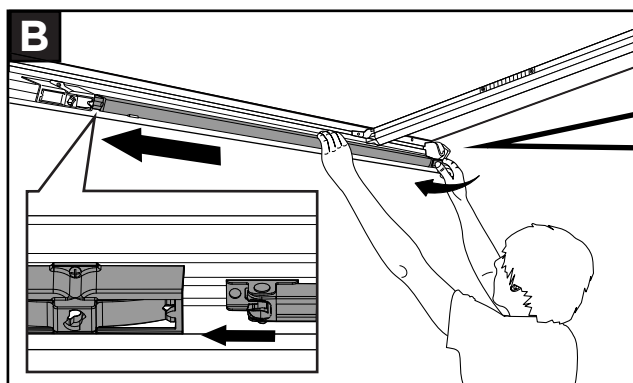
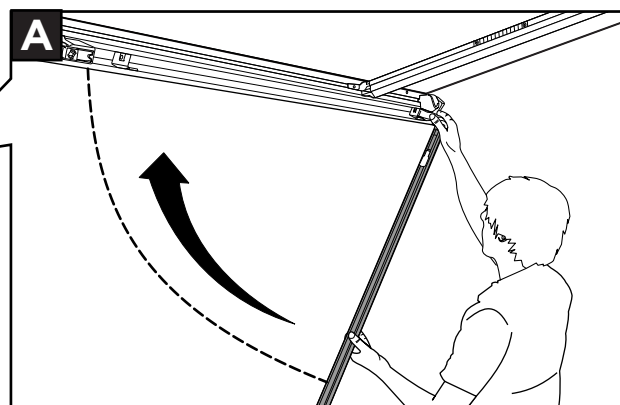
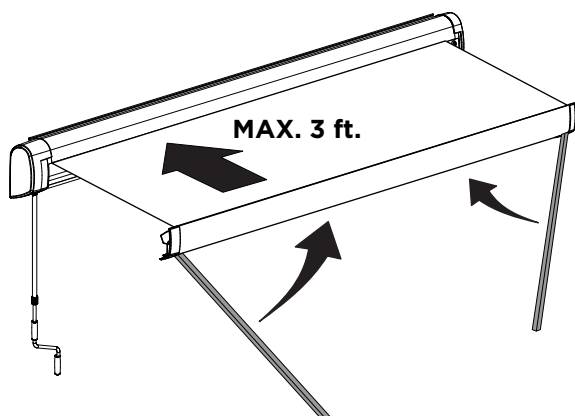

3

